



## 316 Lynton Road, London, SE1 5DD

A one bedroom naturally bright, spacious, apartment within a modern style development. A walk away from South Bermondsey station and the number 1 bus is on the doorstep with access to Tottenham Court Road via Waterloo, Aldwych and Holborn. The apartment boasts an open-plan modern kitchen and reception room with access to a Juliette balcony, a spacious double bedroom, and a modern bathroom. Additional storage can be found in the hallway with full access to the communal area. Centrally located within SE1, ideally placed to enjoy the delights of nearby Bermondsey Street, Surrey Quays and Borough. Other local attractions of note include the food markets of Borough, Bermondsey Square and Maltby Street, and of course many pubs, cafes and restaurants.

- Modern One Bedroom Apartment
- Naturally Bright
- Private Balcony
- Open-Plan Living
- Good Transport Links
- Close to Local Amenities

**Alex & Matteo**  
ESTATE AGENTS

**£1,850 Per month**

# Corelli Court SE1

Approximate Area = 512 sq ft / 47.5 sq m

For identification only - Not To Scale

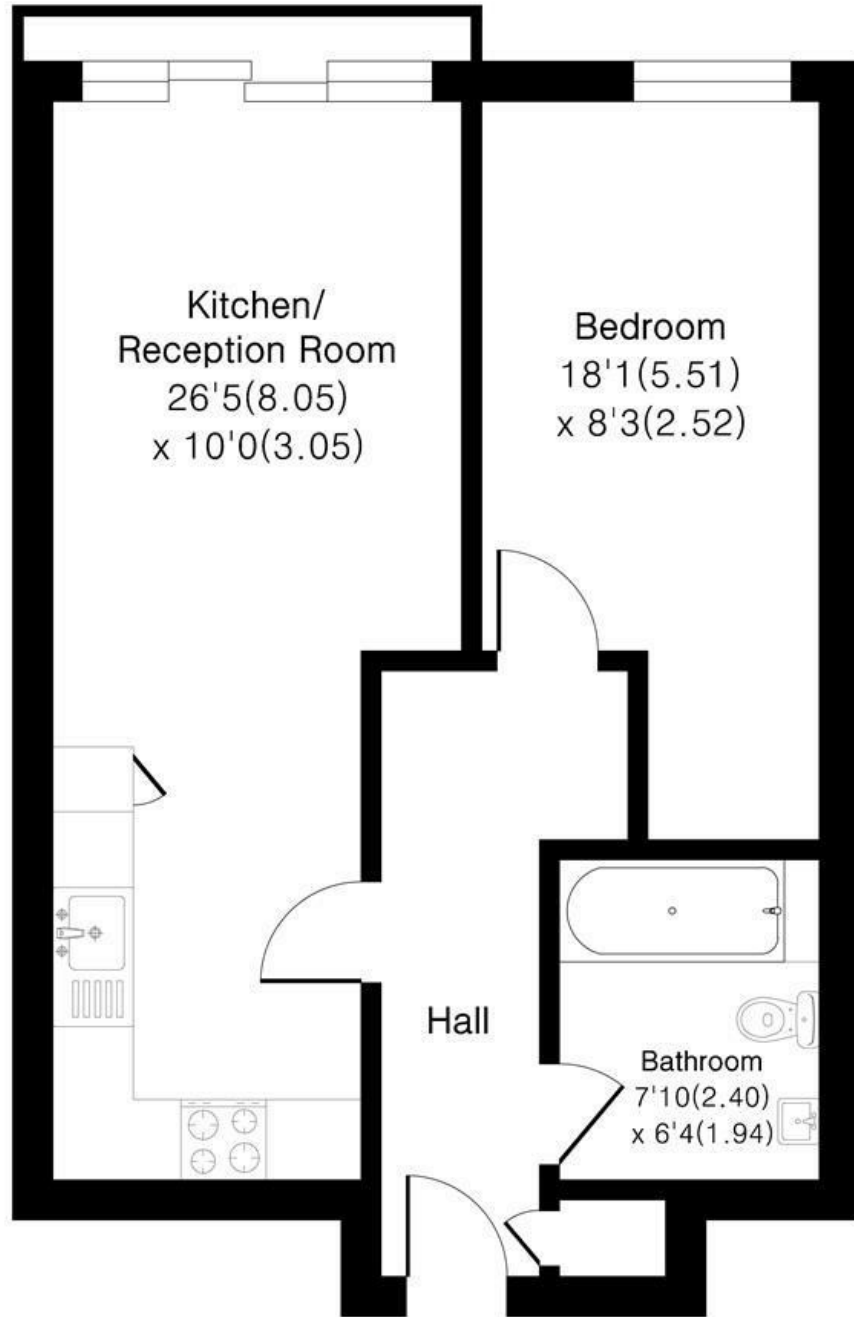

Floor plan Produced in accordance with RICS Property Measurement 2nd Edition. Incorporating International Property Measurement Standards (IPMS2 Residential). Produced for Alex & Matteo Estate Agents.



Energy Efficiency Rating		Current	Potential
Very energy efficient - lower running costs			
(92 plus) <b>A</b>			
(81-91) <b>B</b>		81	81
(69-80) <b>C</b>			
(55-68) <b>D</b>			
(39-54) <b>E</b>			
(21-38) <b>F</b>			
(1-20) <b>G</b>			
Not energy efficient - higher running costs			
<b>England &amp; Wales</b>	EU Directive 2002/91/EC		